

**From:** tid@griffinresiduals.com  
**Sent:** Sat, 20 Dec 2025 03:54:10 +0000  
**To:** aDeSimone@easthamptonct.gov  
**Cc:** jhodge@easthamptonct.gov; engineering@griffinresiduals.com  
**Subject:** Re: 5 Gildersleeve Drive Location  
**Attachments:** 2025-0805 Sample 3B Layout .png

**CAUTION:**

This email originated from outside of the organization. Do not click links or open attachments unless you recognize the sender and know the content is safe. Remember to hover over any links and if you suspect the email is not legitimate or a phishing email, please contact Tom McMahon at x3363.

Thanks, Tony. We can adjust the configuration of the building and receiving/shipment bays. But in general, the CT site will be around 20,000 SF and will require ~2.5 acres. I have attached a sample property 3B layout for visualization. If focused on properties 1 and 1A, we have some models that Trefor can brush off and superimpose them on the topography.

Tid Griffin, CEO  
Griffin Residuals, LLC  
270-485-2680  
[tid@griffinresiduals.com](mailto:tid@griffinresiduals.com)

This message may contain information that is confidential and/or protected by law. If the reader of this message is not the intended recipient, you are hereby notified that any dissemination, distribution, copying or communication of this message is strictly prohibited. If you have received this communication in error, please contact the sender immediately and delete the message.

---

**From:** DeSimone, Anthony <aDeSimone@easthamptonct.gov>  
**Date:** Friday, December 19, 2025 at 5:09 PM  
**To:** Tid Griffin <tid@griffinresiduals.com>  
**Cc:** Hodge, Juliet <jhodge@easthamptonct.gov>  
**Subject:** 5 Gildersleeve Drive Location

Tid,

Juliet and I are going to meet to discuss what can be done about the wetlands on 5 Gildersleeve Drive. We will try to walk the property to see what extent the wetland coverage is. Do you have a realistic concept layout of what size parcel you would be requesting for your Phase 1 and Phase 2 layout assuming the 5 Gildersleeve Drive, 288 West High Street and some of the 1A parcels were made available to you? Please keep in mind the Towns fuel depot is located near the cul da sac and if you needed that area it would have to be relocated. Once we have an idea of how many acres you would be requesting and what the possible wetland impacts are we can discuss with the wetlands chairman to see what are possible options to replicate wetlands or potentially develop a wetlands bank and what contribution would be required for this wetlands bank.

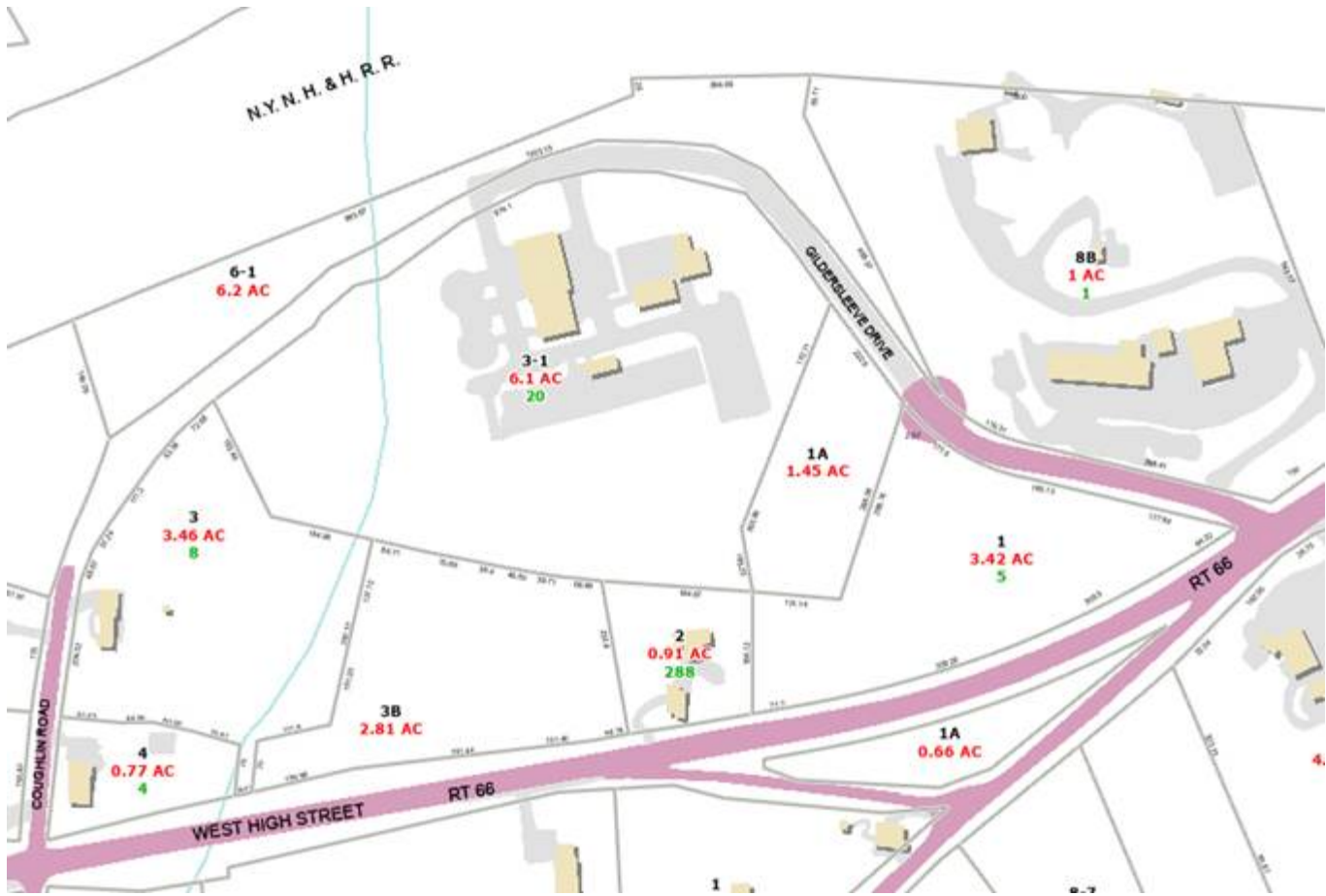

We can setup a call next week if you would like to discuss more.

Thanks,

Tony

Anthony DeSimone, P.E.  
Public Utilities Administrator  
Colchester/East Hampton Joint Facilities WPCF  
P.O. Box 218  
20 Gildersleeve Drive  
East Hampton, CT 06424  
[adesimone@easthamptonct.gov](mailto:adesimone@easthamptonct.gov)  
P: 860-267-2536  
C: 860-510-9869

This electronic message is a public record as defined by the Connecticut Freedom of

Information Act Section 1-200(5). A copy of this message and any reply will be retained by the Town of East Hampton and will be accessible to the public unless exempted by law.

This electronic message is a public record as defined by the Connecticut Freedom of Information Act Section 1-200(5). A copy of this message and any reply will be retained by the Town of East Hampton and will be accessible to the public unless exempted by law.

